

Coastal Slate



Premium Finish Face Mix Technology

Intended to be installed in a truly random pattern this concrete paving stone features the texture of natural sandstone.

TRULY RANDOM PATTERN

The Coastal Slate has an uneven number of pieces of each size on the pallet, allowing you to construct a truly random pattern that emphasizes your own personal style.

COLOURS:



Winter Sky



Birchwood



Espresso

UNIT SIZES: (COMBO MOLD)



6" x 12"



9" x 12"



12" x 12"

RECOMMENDED APPLICATIONS



Patios



Walkways



Residential Driveway/Parking



When installing pavers with raised surfaces it is strongly recommended to use a compactor with a rubber pad to prevent burnishing the raised surface.

BLOCK SPECIFICATION:



No.	Size (in)	PCS / Pallet	Sq.ft. per Pallet	Shipping Weight
1	6" x 12" x 2-3/8" 151mm x 304mm x 60mm	54	108	1433kg / 3000lbs
2	9" x 12" x 2-3/8" 228mm x 304mm x 60mm	36		
3	12" x 12" x 2-3/8" 304mm x 304mm x 60mm [Special Order]	54		

All sizes including 3 mm Spacer Bars

INSTALLATION INSTRUCTIONS:

Permeable Installation

FULL EXFILTRATION

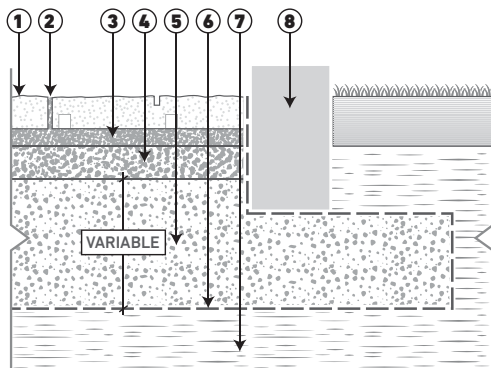

- 1 Paver
- 2 Joint filling material ASTM No 10 (CSA 2-3mm) aggregate
- 3 Bedding course 1 1/5" to 2" (40 to 50 mm) ASTM No 8 (CSA 2.5-10mm) aggregate
- 4 Base course 4" (100mm) ASTM No 57 (CSA 5-28mm) aggregate foundation thickness
- 5 Subbase course ASTM No 2 (CSA 40-80mm) aggregate
- 6 Geotextile (optional)
- 7 Subgrade
- 8 Concrete Edge

Sand Set Installation

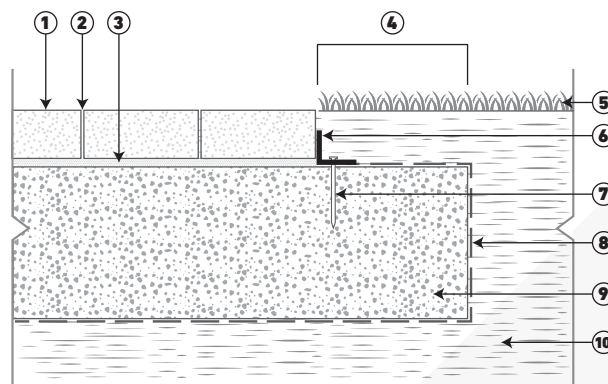

- 1 Paver
- 2 Sand joint fill
- 3 Bedding Sand 1"
- 4 Extra width equal to foundation thickness
- 5 Lawn
- 6 Plastic edge or other type of edge restraint
- 7 Nail
- 8 Geotextile (optional)
- 9 Compacted aggregate base with 3/4" minus material
- 10 Subgrade