

Manhattan VibroPressed Slabs



Premium Finish Face Mix Technology

Classic paving stone slab, ideal for Pool Areas, Rooftops, Decks, Terraces.

VibroPress Technology

Our state-of-the-art manufacturing process is able to bring the quality of slabs to the next level. The dimensional accuracy and high flexural strength make the Manhattan the go to slab for pedestal installations.

COLOURS:

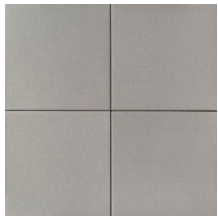

Natural



Charcoal



Winter Sky

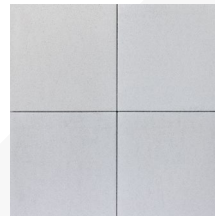

Pearl White



Espresso

AVAILABLE SIZES:



RECOMMENDED APPLICATIONS



Patios



Walkways



Decks



Pedestal Set

BLOCK SPECIFICATION:



Size (in)	Pieces per sq.ft.	Sq.ft. per Pallet	Shipping Weight	PCS / Pallet
"12" x 24" x 2"	0.5	88	1000kg / 2200lbs	44
"18" x 18" x 2"	0.44	99	1113kg / 2454lbs	44
"18" x 36" x 2"	0.22	99	1113kg / 2454lbs	22
"24" x 24" x 2"	0.25	88	1000kg / 2200lbs	22
"24" x 36" x 2"	0.17	132	1472kg / 3246lbs	22

All sizes including 3 mm Spacer Bars

INSTALLATION INSTRUCTIONS:

Permeable Installation

FULL EXFILTRATION

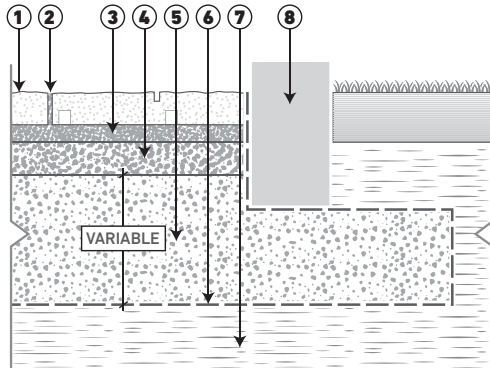

- 1 Slab
- 2 Joint filling material ASTM No 10 (CSA 2-3mm) aggregate
- 3 Bedding course 1 1/5" to 2" (40 to 50 mm) ASTM No 8 (CSA 2.5-10mm) aggregate
- 4 Base course 4" (100mm) ASTM No 57 (CSA 5-28mm) aggregate foundation thickness
- 5 Subbase course ASTM No 2 (CSA 40-80mm) aggregate
- 6 Geotextile (optional)
- 7 Subgrade
- 8 Concrete Edge

Sand Set Installation

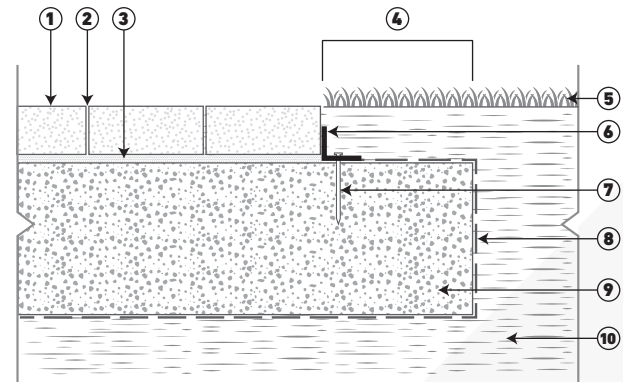

- 1 Slab
- 2 Sand joint fill
- 3 Bedding Sand 1"
- 4 Extra width equal to foundation thickness
- 5 Lawn
- 6 Plastic edge or other type of edge restraint
- 7 Nail
- 8 Geotextile (optional)
- 9 Compacted aggregate base with 3/4" minus material
- 10 Subgrade

Pedestal Set Installation

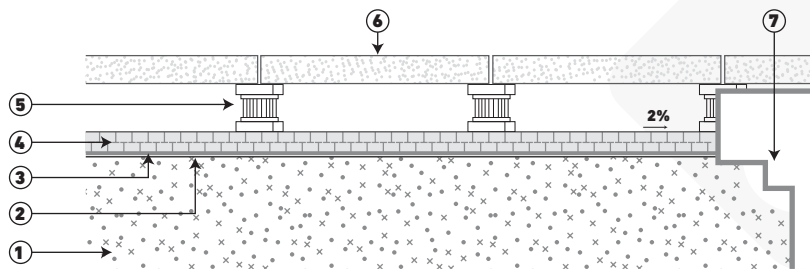

- 1 Structural deck
- 2 Waterproof membrane
- 3 Protection board and/or Drain mat
- 4 Rigid insulation
- 5 Pedestals
- 6 Slab
- 7 Roof drain